

REVISIONS			
LTR	DESCRIPTION	DATE	APPROVED
A			
B	CORRECT P/N ITEMS 3, 4, 7 & 13. CORRECT QTY ITEM 8	7/87	A.Z.
C	CHANGED ITEM 2 FROM 1398 TO 1399-1	8/88	A.Z.

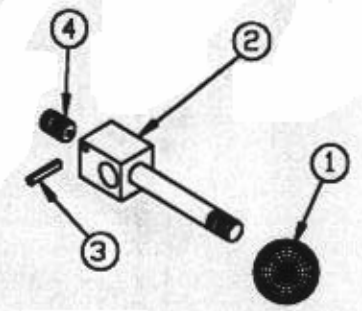
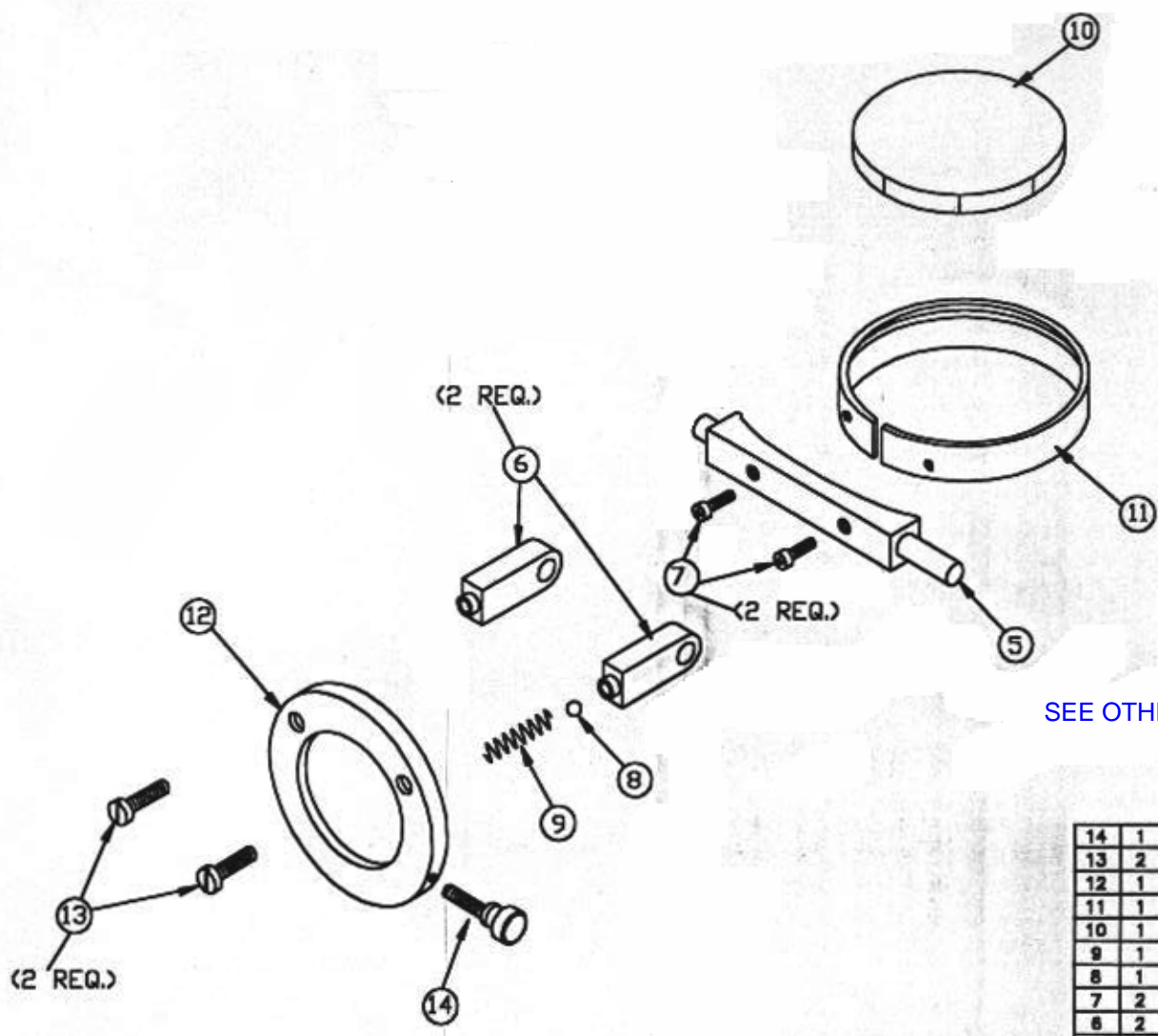

SEE OTHER SIDE FOR ENLARGED BILL OF MATERIALS

14	1	1394	SCREW-KNURLED, 4-40 X 1/2 LONG
13	2	2044	SCREW, 4 X 10MM SLOTTED
12	1	1398	RING CLAMP
11	1	1387	GLASS RETAINER RING
10	1	1385	FILTER GLASS, (OPTIONAL)
9	1	1274	SPRING, 1/8 DIA. X .800 LONG
8	1	1401	BALL BEARING, STEEL 1/8 DIA.
7	2	2182	SCREW, 2-56 X 1/4 LONG
6	2	1398	STAND-OFF
5	1	1400	FILTER BRACKET
4	1	0702	SET SCREW, 8-32 X 1/8
3	1	0821	ROLLED PIN
2	1	1399-1	FILTER ARM
1	1	1257	KNOB

NEXT ASSY. USE ON APPLICATION <small>THIS DRAWING AND SPECIFICATIONS ARE THE PROPERTY OF GENERAL RESEARCH LABORATORIES AND SHALL NOT BE REPRODUCED, COPIED, USED OR RELEASED IN ANY MANNER WITHOUT THE APPROVAL OF GENERAL RESEARCH LABORATORIES.</small>	ITEM QTY. GRP. P/N DESCRIPTION:	FILE NAME ISOASSEM APPROVAL DATE OVER NON ENCLOSED 10/16/88 CHECKED X X APPROVED X X	GENERAL RESEARCH LABORATORIES DIVISION OF FREZZOLINI ELECTRONICS INC. 5 VALLEY STREET HAWTHORNE, NEW JERSEY 07508
	DO NOT SCALE DRAWING MATERIAL FINISH	ASSEMBLY, MFDF SIZE: CODE IDENT DRAWING NO. REV. C 03893 MFDF C SCALE: --- SHEET: 1 of 1	

14	1	1394	SCREW-KNURLED, 4-40 X 1/2 LONG
13	2	2044	SCREW, 4 X 10MM SLOTTED
12	1	1396	RING CLAMP
11	1	1397	GLASS RETAINER RING
10	1	1385	FILTER GLASS, (OPTIONAL)
9	1	1274	SPRING, 1/8 DIA. X .800 LONG
8	1	1401	BALL BEARING, STEEL 1/8 DIA.
7	2	2182	SCREW, 2-56 X 1/4 LONG
6	2	1398	STAND-OFF
5	1	1400	FILTER BRACKET
4	1	0702	SET SCREW, 6-32 X 1/8
3	1	0821	ROLLED PIN
2	1	1399-1	FILTER ARM
1	1	1257	KNOB
ITEM	QTY.	GRL P/N	DESCRIPTION:

UNLESS OTHERWISE SPECIFIED:
SURFACE ROUGHNESS IS AA 43/ MAX.
DIMENSIONS ARE AFTER FINISH.
DIMENSIONS ARE IN INCHES.
TOLERANCES ARE:

FRACTIONS	DECIMALS	ANGLES
±1/64	.XX ± .02	± Z'
	.XXX ± .005	

DO NOT SCALE DRAWING

FILE NAME		ISOASSEM	
APPROVALS		DATE	
DRAWN	RON MCCLOUD	10/10/95	
CHECKED	X	X	
APPROVED	X	X	

GENERAL RESEARCH LABORATORY
DIVISION OF FREZZOLINI ELECTRONICS
5 VALLEY STREET
HAWTHORNE, NEW JERSEY 0750

ASSEMBLY, MFDF

MATERIAL

△
X

FINISH

△
X

SIZE:	CODE IDENT	DRAWING NO.
C	03893	MFDF
SCALE: ---	SHEET: 1	